

CAVALLETTO

Design: Luigi Caccia Dominioni, 1947

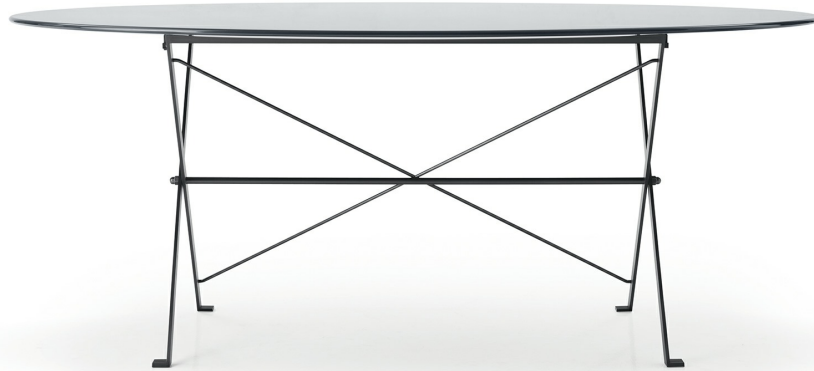

Its frame is simplicity to a T, a drawing on a sheet of paper that has magically materialised into a full-sized table. The architect drew inspiration from the easels (cavalletti) he worked on at Milan's technical university, the Politecnico. This single object epitomises all the key elements of Luigi Caccia Dominioni's design: sophisticated curves, clean straight lines, a creation that meets its specifications, is easy to use, simple not mundane and portrays the beauty of minimalism. Thanks to being balanced and proportioned, Cavalletto will never show its age and proudly continues to enjoy contemporary classic status that will last long into the future.

AZUCENA

CAVALLETTO

Design: Luigi Caccia Dominioni, 1947

Technical data

Oval tables

D_TV1

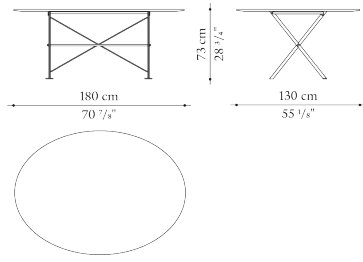

D_TV2

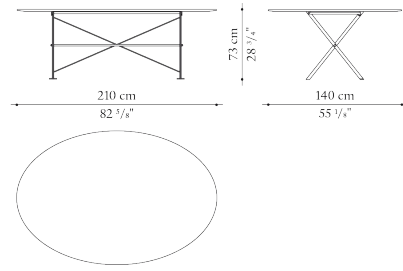

Top

laquered MDF wood fibre or marble with polyester finish

Base-frame

painted steel

Ferrules

plastic material

CAVALLETTO

Design: Luigi Caccia Dominioni, 1947

Finishes

Glossy lacquered



1006L
Glossy anthracite grey



3764L
Glossy black



4002L
Glossy English green



7003L
Glossy China red

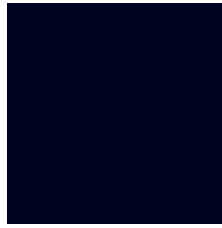

8004L
Glossy navy blue

Marbles



0184P
Glossy Calacatta white
marble

Metals



0580T
Brass finish



0600C
Chromed finish

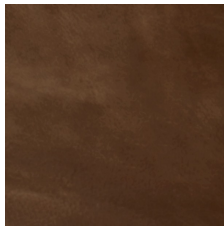

0905B
Bronzed finish